

LEGEND

1.	Protective Thread Sleeve	x1
2.	Large Screw Head (M36)	x1
3.	Hex Key Round Cap Screw (M8)	x2
4.	Bearing	x2
5.	Metal Gasket (M6)	x2
6.	Main Body	x1
7.	Tool Handle	x1
8.	Positioning Flange	x1
9.	Hex Key Round Cap Screw (M6)	x1
10.	Hex Key Round Cap Screw (M6)	x1

STEP 1

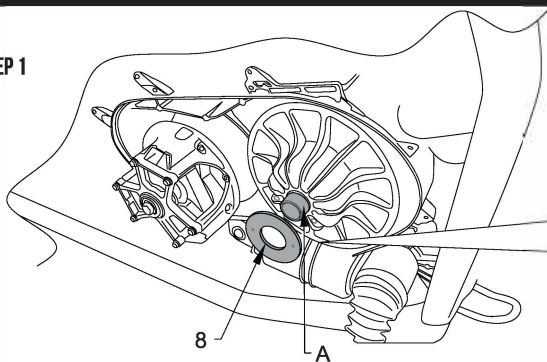

1. Align the positioning flange (8) over the secondary shaft (A) and press down by hand.

STEP 2

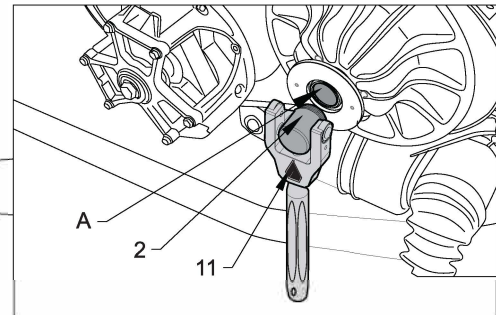

2. Rotate the tool (11) to thread into secondary shaft (2) to figure (A).

STEP 3

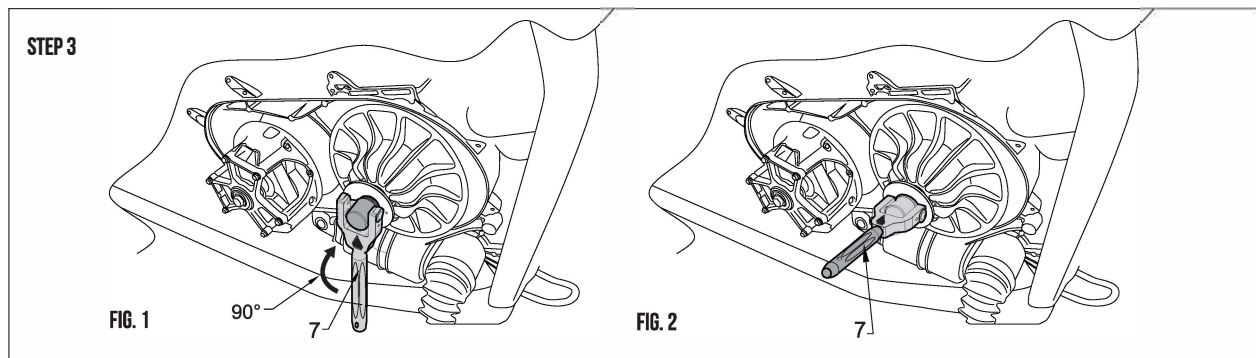

3. Lift up the handle (7) 90° to depress the belt pulley - you can easily remove and replace the belt.
4. Perform the above steps in reverse to remove the tool and complete the belt replacement procedure.